



* £250,000- £270,000 * LARGE GROUND FLOOR FLAT * TWO SPACIOUS BEDROOMS * ACCESS TO YOUR OWN PRIVATE GARDEN * CENTRAL LEIGH-ON-SEA LOCATION * Situated on the ever-popular London Road in the charming seaside town of Leigh-on-Sea, this exceptional ground floor apartment, built in the 1930s, offers a delightful blend of traditional character and modern convenience. Boasting two generously sized bedrooms, this extra-large flat is perfect for those seeking both space and comfort. As you enter, you are welcomed by a

- No service charge, very low ground rent and a long lease
- Direct access to own garden
- Spacious bay-fronted lounge
- Traditional features including fireplaces throughout
- Short walk to Leigh Road and Leigh Broadway shopping facilities
- Large ground floor flat with two generously sized bedrooms
- Fully fitted kitchen-diner
- Modern bathroom suite
- Central Leigh-on-Sea location
- Walking distance to Chalkwell and Leigh Train Station

London Road

Leigh-on-Sea

£250,000

Price Guide



London Road



Frontage

Shared front garden with a pathway leading to the front door. spacious bay-fronted lounge, which is bathed in natural light and features traditional fireplaces that add a touch of character to the living space. The fully fitted kitchen-diner is ideal for culinary enthusiasts, providing ample room for dining and entertaining. The modern bathroom suite complements the apartment's character, ensuring a comfortable living experience. One of the standout features of this property is the direct access to your own private garden, a rare find in this area, offering a tranquil outdoor space for relaxation or gardening enthusiasts.

Lounge

17'0" x 10'11" Double glazed bay windows to the front, with the top windows obscured, picture rail, coved ceiling with a ceiling rose, feature fireplace opening with a tiled hearth and wooden surround laminate flooring.

Kitchen-Diner

13'2" x 11'0" Smooth coved ceiling with a pendant light, wooden door to the rear leading out to the garden, obscured window above the doors, double glazed window to the rear overlooking the garden. Modern shaker style kitchen comprising of; wall and base level units with a square edge laminate worktop, ceramic sink and drainer with a chrome mixer tap, space for a fridge freezer, space for a washing machine, range cooker with a five ring gas hob and an extractor fan above, wall mounted Worcester boiler, tiled splashback, drawers, integrated slimline dishwasher, built in storage cupboard, double radiator, lino flooring.

Bedroom One

14'11" x 9'9" Smooth coved ceiling with a pendant light, picture rails, double glazed windows to the front, double radiator, feature fireplace with a tiled hearth and a wooden surround, laminate flooring.

Bedroom Two

12'4" x 10'9" Pendant light, double glazed windows to the rear overlooking the garden, feature fireplace with a tiled hearth and a wooden surround, vertical column radiator, laminate flooring.

Bathroom

12'0" x 4'9" Smooth ceiling, obscured double glazed window to the rear, tiled bath with a shower over, low-level WC, vanity unit wash basin with a tiled splashback, chrome heated towel rail, patterned tiled floor.

Rear Garden

Commences with a raised decking area with the remainder laid to lawn, shingled area to the rear with a bench seat.



Floor Plan

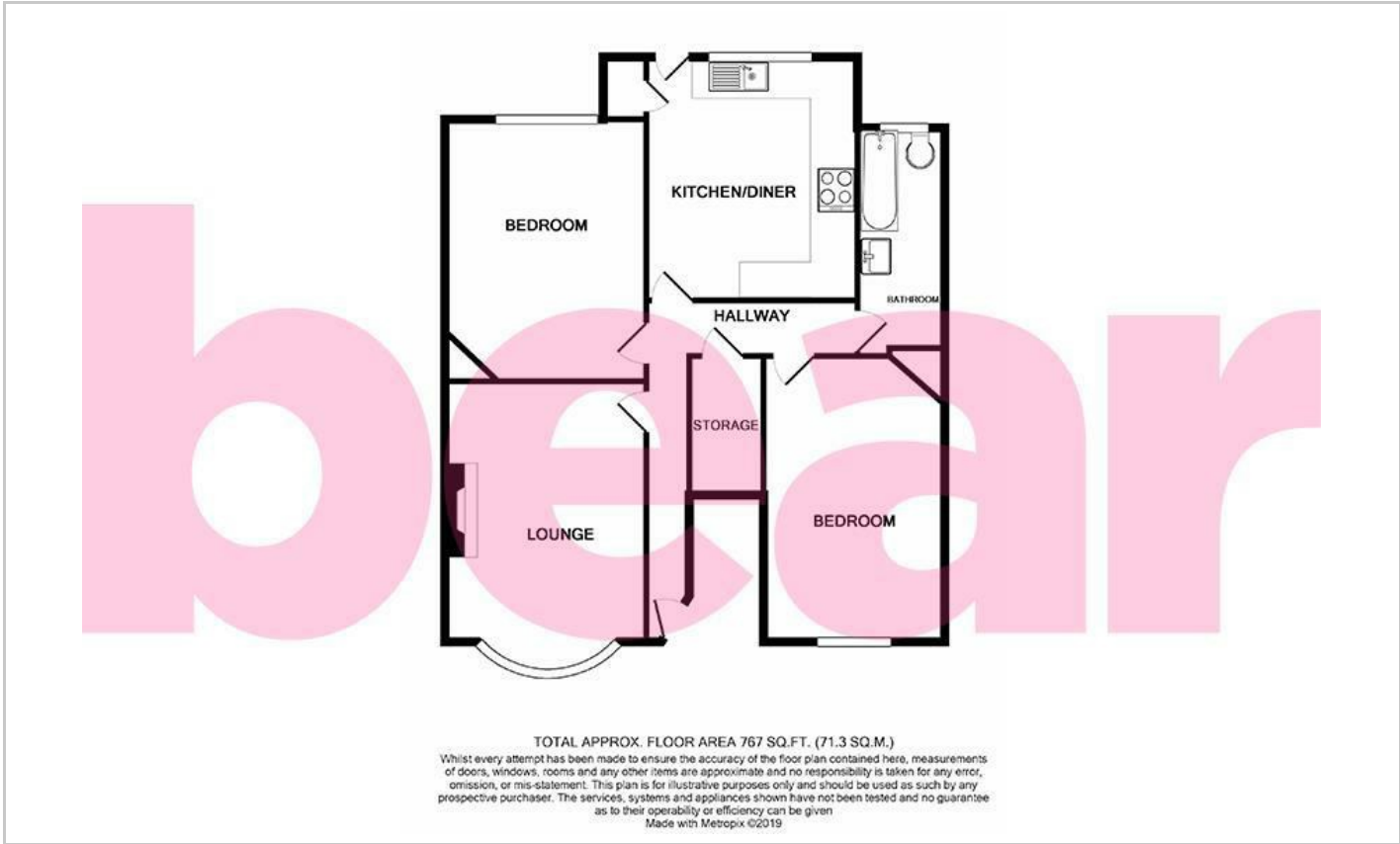

Area Map

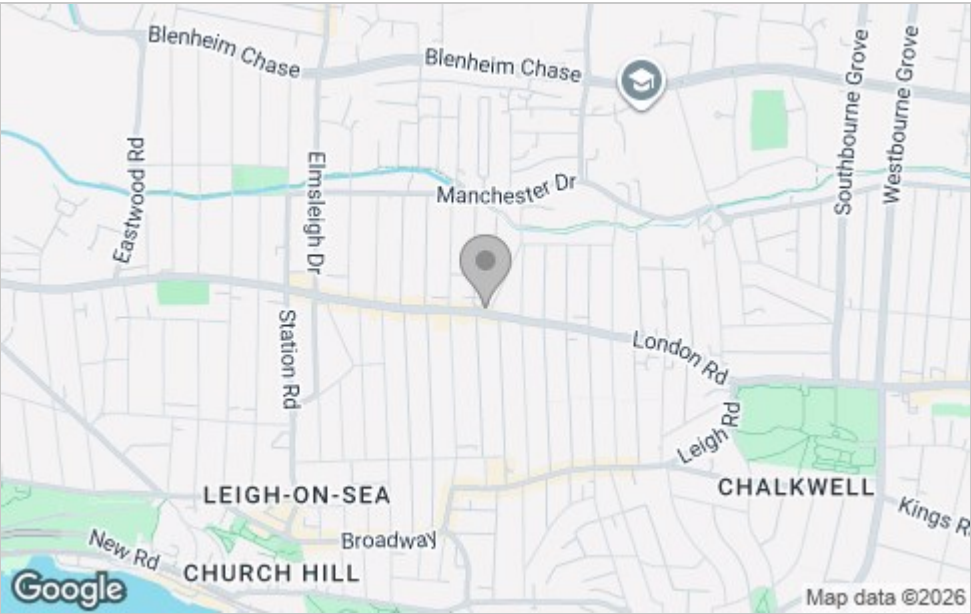

Viewing

Please contact our Leigh-on-Sea Office on 01702 887 496 if you wish to arrange a viewing appointment for this property or require further information.

These particulars, whilst believed to be accurate are set out as a general outline only for guidance and do not constitute any part of an offer or contract. Intending purchasers should not rely on them as statements of representation of fact, but must satisfy themselves by inspection or otherwise as to their accuracy. No person in this firms employment has the authority to make or give any representation or warranty in respect of the property.

1336 London Road, Leigh-on-Sea, Essex, SS9 2UH

Office: 01702 887 496 los@beaestateagents.co.uk <http://www.beaestateagents.co.uk/>

Energy Efficiency Graph

